

AUTO-REVERSE TAPPING & CORE DRILLING MACHINE

FULLY MECHANICAL Tapping with **automatic reversing** controlled by crank motion. **No electronics!** **Two-mode gearbox:** one mode for auto-reverse tapping and one mode for annular cutters and twist drills. Quick-release spindle for fast, tool-free switching of accessories.



Drill Chuck Arbor
(Twist drill not included)



Annular Cutter Arbor
(Annular cutter and pilot pin not included)



Coolant Tank
Coolant Feed Tap

Crank Handle
Mode Selector (for shifting to Auto-reverse tapping mode or standard drilling mode)

Motor Switch
Magnet Switch
Magnetic Base

Quick Release Collar
Tap Collet Arbor
Travel Limiter Stop
Tap (Not included)



Depth Meter

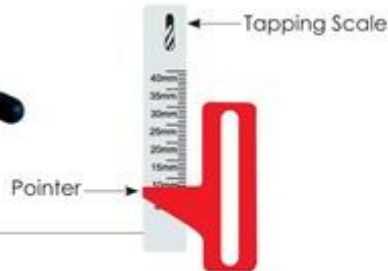

Mode Selector

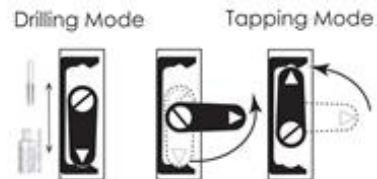

Mode Selector

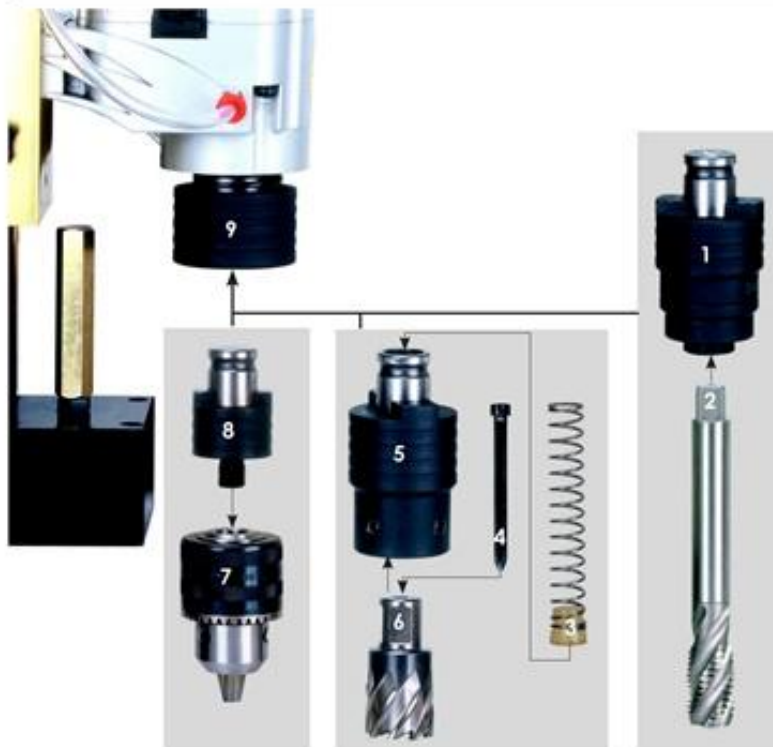

1. Tap Collet Arbor
2. Tap (Not included)
3. Coolant Feed Spring And Seal
4. Pilot Pin (Not included)
5. Annular Cutter Arbor
3/4" (19.05mm)Weldon Shank
6. Annular Cutter (Not included)
7. 1/2" Twist Drill Chuck
8. Drill Chuck Arbor
9. Quick-Release Collar

■ TP2000 Tap Collet Arbors

Part Number	For Tap Sizes:
0202-0060-00000-010	M8 DIN376
0202-0060-00000-011	M10 DIN376
0202-0060-00000-001	M12 DIN376
0202-0060-00000-002	M14 DIN376
0202-0060-00000-003	M16 DIN376
0202-0060-00000-004	M18 DIN376/JIS
0202-0060-00000-005	M20 DIN376
0202-0060-00000-006	M12 JIS
0202-0060-00000-007	M14 JIS
0202-0060-00000-008	M16 JIS
0202-0060-00000-009	M20 JIS

■ TP2000 Drill Chuck Arbor

Arbor for 1/2" Chuck (1/2"-20 UNF)

Part Number 0202-0059-00907-001

■ TP2000 Annular Cutter Arbor

Arbor for 3/4" (19.05mm) Weldon Shank

Annular Cutters

Part Number 0202-0058-00907-001

OPTIONAL ACCESSORIES:



Annular Cutter



Pilot Pin



Magnetic Chip Collector

(Patented)

Model	TP2000
Power Input	1100W
Voltage	110-120V~ 50-60Hz, 220-240V~ 50-60Hz
Drilling Mode No / Full Load min ⁻¹	550 / 330
Tapping Mode No / Full Load min ⁻¹	150 / 90
Annular Cutter Arbor	Set Screw Type, 19.05mm Weldon Shank
Annular Cutters	Dia. 35mmX50mm (1-3/8" X 2")
Taps	20mmX40mm (13/16"X1-9/16")
Twist Drills	13mmX150mm (1/2" X6")
Magnetic Adhesion	15,000 N (3,372 lb-f)
Net Weight	13.7kg (30.8 Lbs)



STANDARD ACCESSORIES

- * Wrench M8
- * 2.5mm L-Hex Key
- * 4mm L-Hex Key
- * Drill Chuck Arbor
- * 1/2" Chuck And Chuck Key
- * Annular Cutter Arbor
3/4" (19.05mm)Weldon Shank
- * 5 Tap Collet Arbors In Sizes: M12, M14, M16, M18 & M20 (DIN376/JIS)
- * Coolant Tank Kit
- * Chip Guard Kit
- * Safety Chain
- * Blow Molded Case

OPTIONAL ACCESSORIES

- * Other Sizes of Tap Collet Arbors
- * Overload Protection